

Plat Slide 441, page 206

WESTVACO  
 ET. PLATS  
 4-158  
 5-217  
 E-156

MYRTLE H. WILKES ESTATE  
 APPROX. 9 MILES WEST OF WINNSBORO, FAIRFIELD COUNTY, S.C.  
 NOVEMBER 5, 1984  
 SCALE: 1"=400'

SURVEYED BY GLENN ASSOCIATES LAND SURVEYING COMPANY  
 JENKINSVILLE, S.C.

W. T. GLENN, III, R.L.S., #4910  
 I HEREBY CERTIFY THAT THE RATIO OF PRECISION OF THE FIELD SURVEY (UNADJUSTED) WAS 1/10,000 OR BETTER AND THE AREA WAS DETERMINED BY DND METHOD OF CALCULATION.  
 NOTE: PLAT REVISION ON APRIL 7, 1989 TO SHOW DIVISION LINES RUN IN FEBRUARY, 1989 BY GLENN ASSOCIATES LAND SURVEYING COMPANY.



The within PLAT recorded this 19th day of April 1989 in PLAT 441, page 206, is the work of DORCAS C. ANDERSON, Clerk of Court of Common Pleas & General Sessions, Fairfield County, S.C.

WESTVACO  
 PARCEL "A"  
 108.70 AC.

WESTVACO  
 PARCEL "B"  
 173.82 AC.

WESTVACO  
 PARCEL "C"  
 182.77 AC.

WESTVACO  
 PARCEL "D"  
 10.20 AC.

WESTVACO  
 PARCEL "E"  
 10.06 AC.

WESTVACO  
 PARCEL "F"  
 10.06 AC.

WESTVACO  
 PARCEL "G"  
 10.06 AC.

WESTVACO  
 PARCEL "H"  
 10.06 AC.

WESTVACO  
 PARCEL "I"  
 10.06 AC.

LINE NO.	BEARINGS & DISTANCES
1	N 28° 29' 26" E 60.00'
2	N 4° 01' 42" E 1397.59'
3	N 7° 33' 14" W 1258.43'
4	N 3° 53' 38" W 2444.11'
5	N 4° 01' 38" W 189.50'
6	N 8° 21' 36" E 551.60'
7	S 86° 42' 29" E 517.39'
8	S 89° 56' 27" E 1077.64'
9	S 3° 35' 00" W 1365.39'
10	S 46° 24' 07" E 1542.77'
11	S 68° 05' 42" E 1600.50'
12	S 7° 18' 28" W 550.00'
13	S 1° 49' 27" E 1120.00'
14	S 79° 28' 20" W 75.00'
15	N 73° 38' 18" W 139.69'
16	S 53° 37' 29" W 120.14'
17	S 33° 56' 38" W 299.81'
18	S 7° 54' 32" W 70.00'
19	N 33° 43' 29" W 95.08'
20	N 55° 43' 48" W 266.43'
21	S 8° 38' 41" W 309.39'
22	S 7° 02' 35" W 283.42'
23	S 7° 02' 35" W 283.42'
24	S 7° 02' 35" W 283.42'
25	S 7° 02' 35" W 283.42'
26	S 7° 02' 35" W 283.42'
27	S 7° 02' 35" W 283.42'
28	S 7° 02' 35" W 283.42'
29	S 7° 02' 35" W 283.42'
30	S 7° 02' 35" W 283.42'
31	S 7° 02' 35" W 283.42'
32	S 7° 02' 35" W 283.42'
33	S 7° 02' 35" W 283.42'
34	S 7° 02' 35" W 283.42'
35	S 7° 02' 35" W 283.42'
36	S 7° 02' 35" W 283.42'
37	S 7° 02' 35" W 283.42'
38	S 7° 02' 35" W 283.42'
39	S 7° 02' 35" W 283.42'
40	S 7° 02' 35" W 283.42'
41	S 7° 02' 35" W 283.42'
42	S 7° 02' 35" W 283.42'
43	S 7° 02' 35" W 283.42'
44	S 7° 02' 35" W 283.42'
45	S 7° 02' 35" W 283.42'
46	S 7° 02' 35" W 283.42'
47	S 7° 02' 35" W 283.42'
48	S 7° 02' 35" W 283.42'
49	S 7° 02' 35" W 283.42'
50	S 7° 02' 35" W 283.42'
51	S 7° 02' 35" W 283.42'
52	S 7° 02' 35" W 283.42'
53	S 7° 02' 35" W 283.42'
54	S 7° 02' 35" W 283.42'
55	S 7° 02' 35" W 283.42'
56	S 7° 02' 35" W 283.42'
57	S 7° 02' 35" W 283.42'
58	S 7° 02' 35" W 283.42'
59	S 7° 02' 35" W 283.42'
60	S 7° 02' 35" W 283.42'
61	S 7° 02' 35" W 283.42'
62	S 7° 02' 35" W 283.42'
63	S 7° 02' 35" W 283.42'
64	S 7° 02' 35" W 283.42'
65	S 7° 02' 35" W 283.42'
66	S 7° 02' 35" W 283.42'
67	S 7° 02' 35" W 283.42'
68	S 7° 02' 35" W 283.42'
69	S 7° 02' 35" W 283.42'
70	S 7° 02' 35" W 283.42'
71	S 7° 02' 35" W 283.42'
72	S 7° 02' 35" W 283.42'
73	S 7° 02' 35" W 283.42'
74	S 7° 02' 35" W 283.42'
75	S 7° 02' 35" W 283.42'
76	S 7° 02' 35" W 283.42'
77	S 7° 02' 35" W 283.42'
78	S 7° 02' 35" W 283.42'
79	S 7° 02' 35" W 283.42'
80	S 7° 02' 35" W 283.42'
81	S 7° 02' 35" W 283.42'
82	S 7° 02' 35" W 283.42'
83	S 7° 02' 35" W 283.42'
84	S 7° 02' 35" W 283.42'
85	S 7° 02' 35" W 283.42'
86	S 7° 02' 35" W 283.42'
87	S 7° 02' 35" W 283.42'
88	S 7° 02' 35" W 283.42'
89	S 7° 02' 35" W 283.42'
90	S 7° 02' 35" W 283.42'
91	S 7° 02' 35" W 283.42'
92	S 7° 02' 35" W 283.42'
93	S 7° 02' 35" W 283.42'
94	S 7° 02' 35" W 283.42'
95	S 7° 02' 35" W 283.42'
96	S 7° 02' 35" W 283.42'
97	S 7° 02' 35" W 283.42'
98	S 7° 02' 35" W 283.42'
99	S 7° 02' 35" W 283.42'
100	S 7° 02' 35" W 283.42'

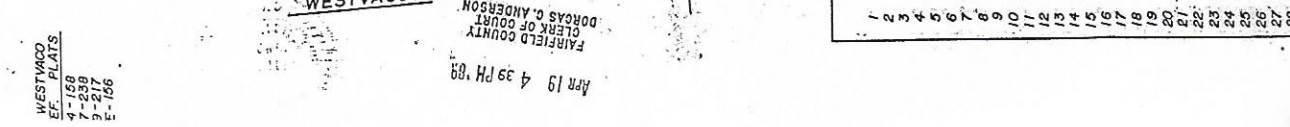

DATE: 4-19-89  
 SUBDIVISION REGULATIONS  
 DO NOT APPLY  
 Administrative Official

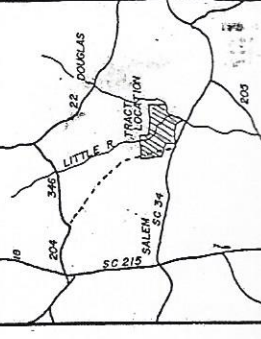

WESTVACO  
 CLERK OF COURT  
 FAIRFIELD COUNTY  
 APR 19 4 39 PM '89